

# Z-Coordinate of a plane

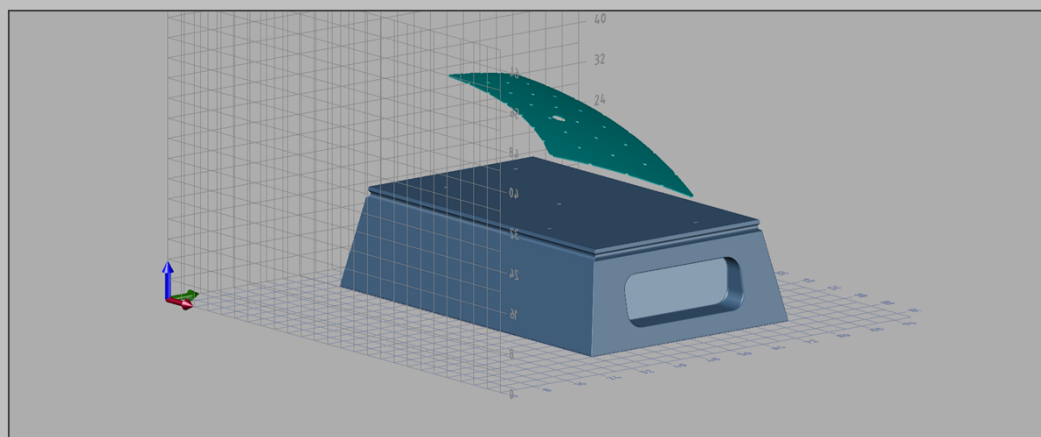

# Z-Coordinate of a plane

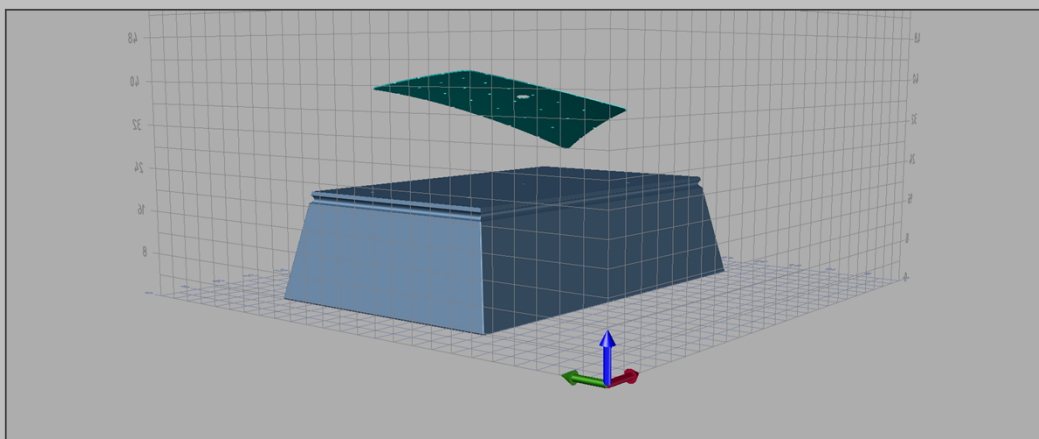
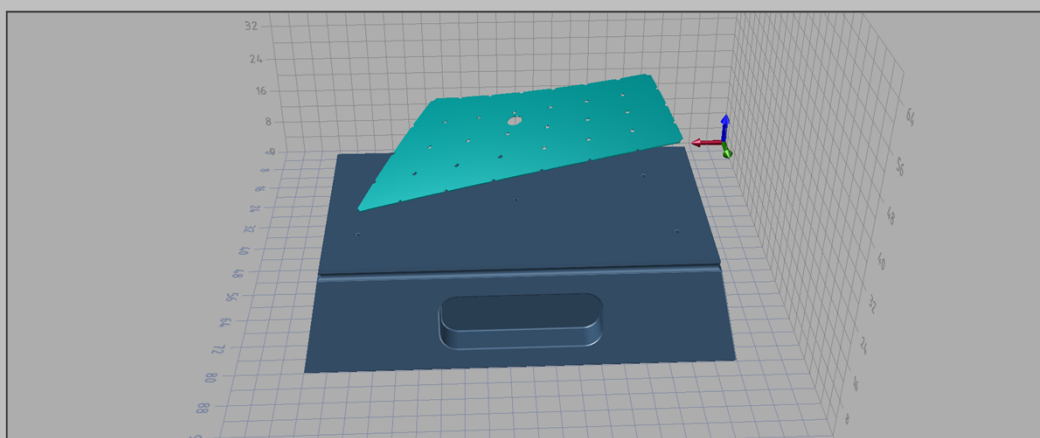
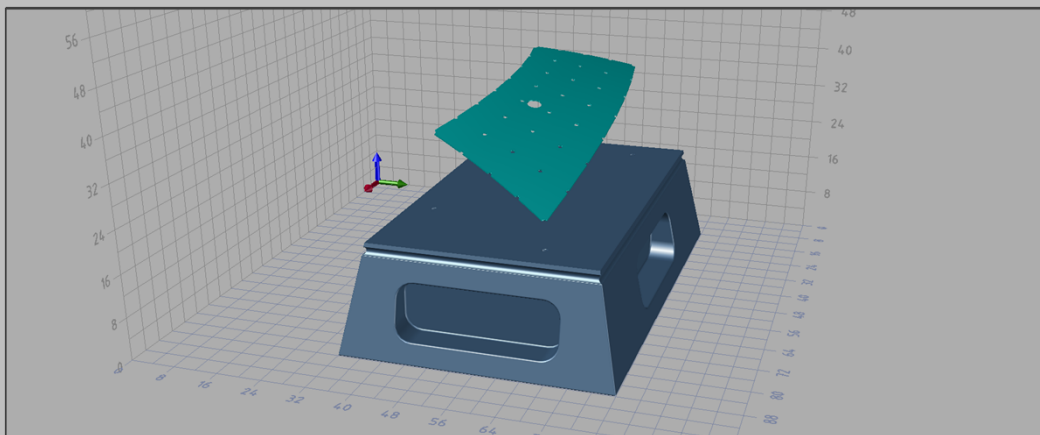
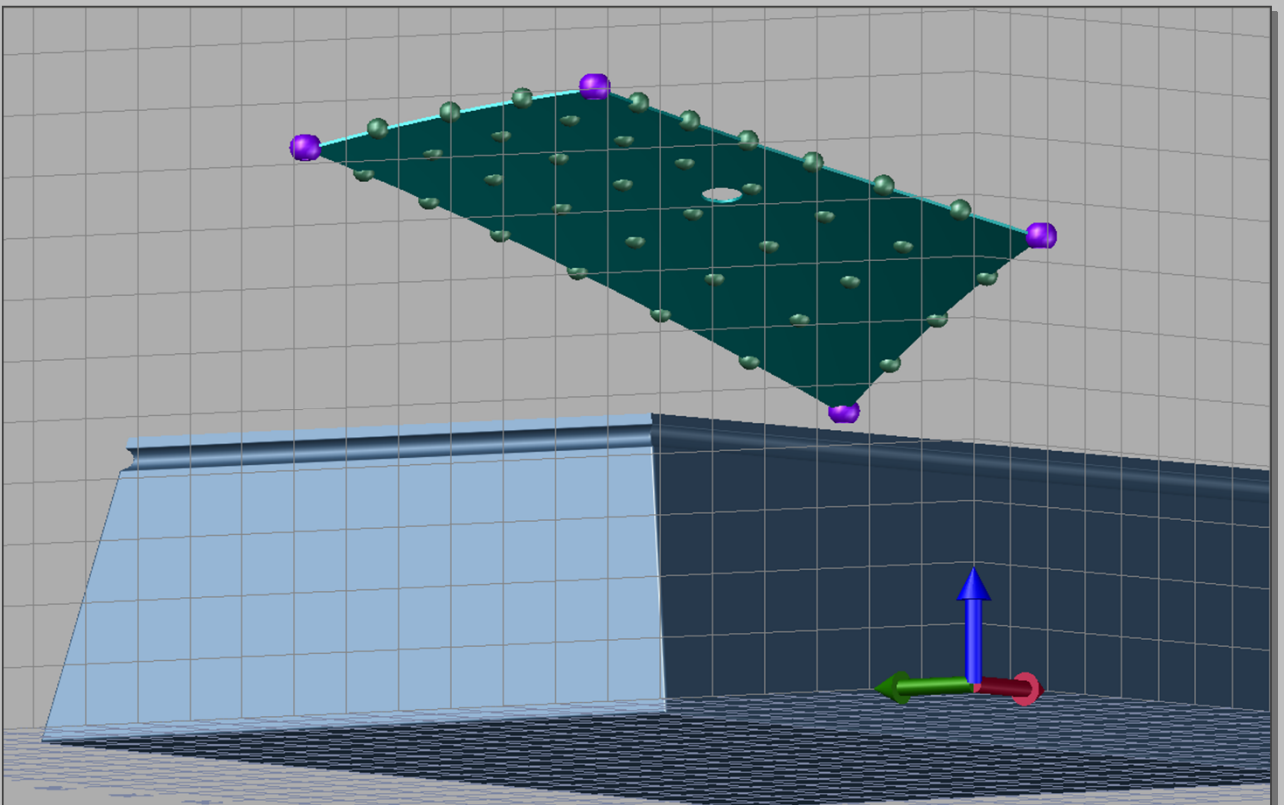
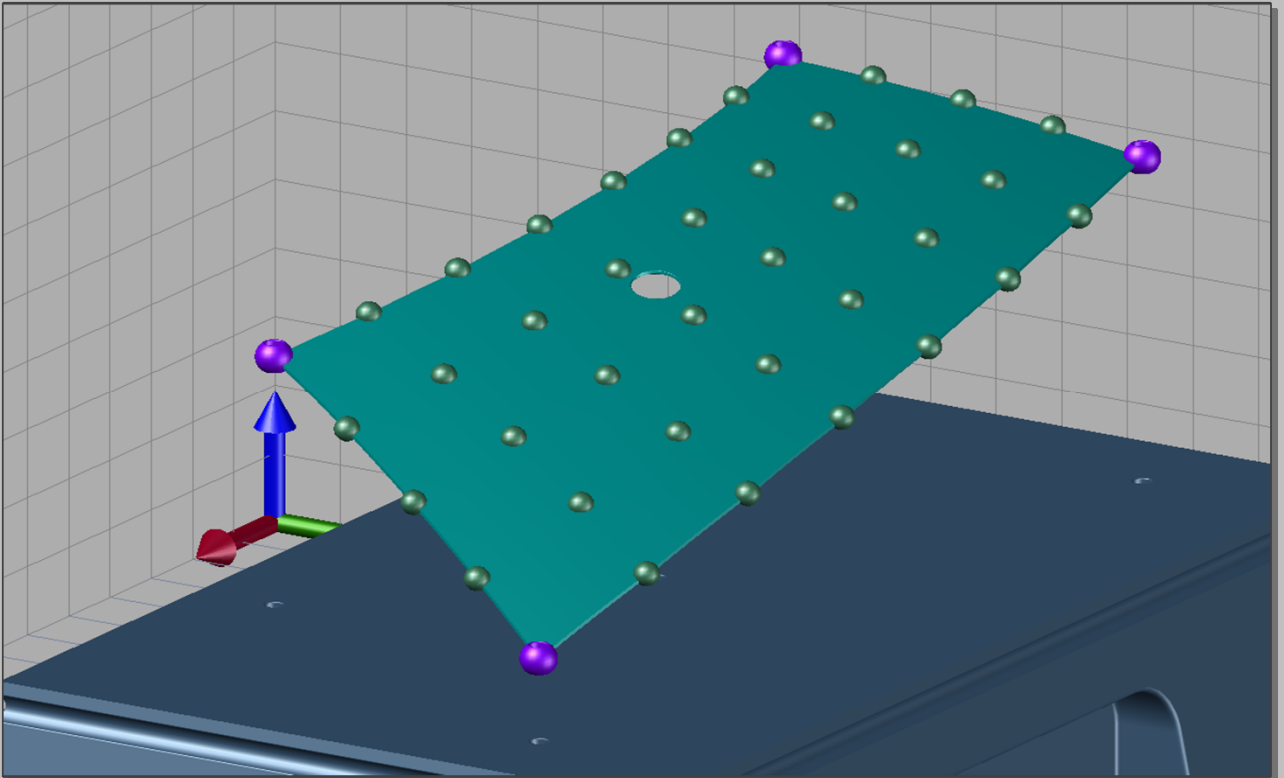

# Z-Coordinate of a plane

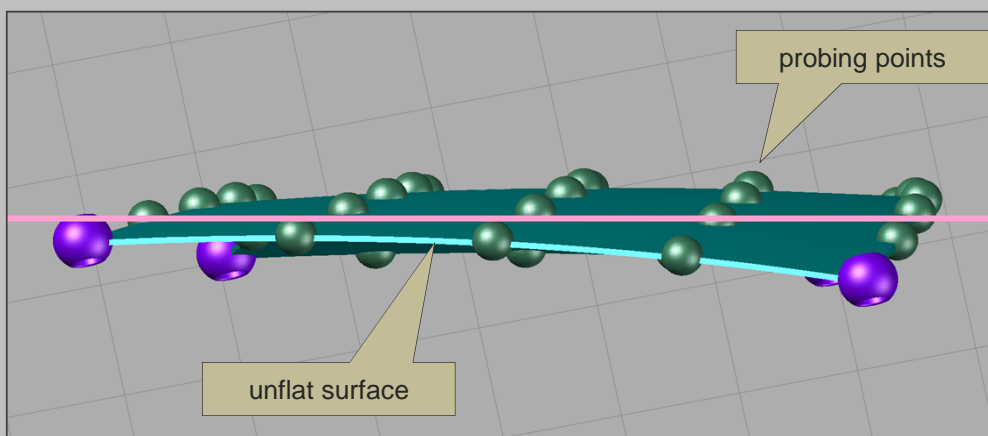
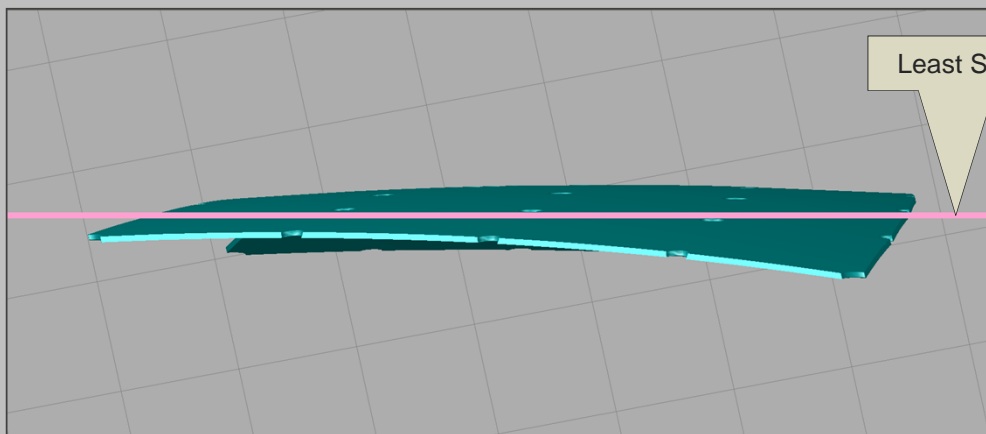
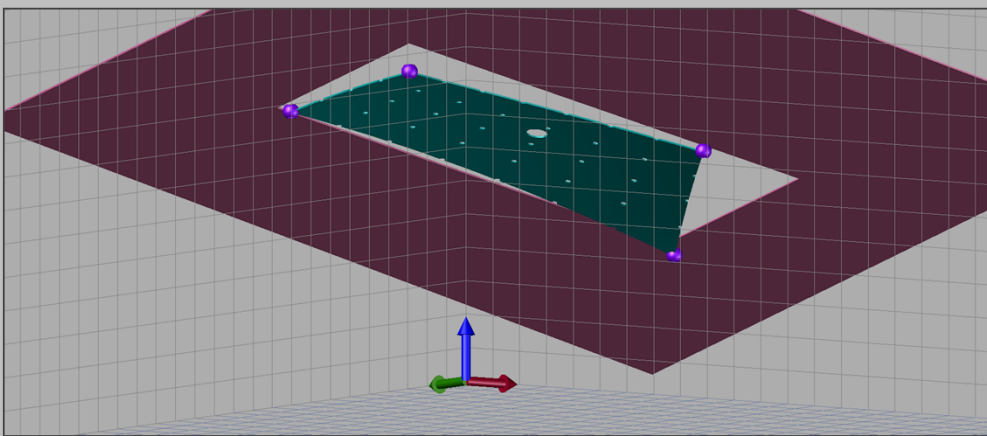
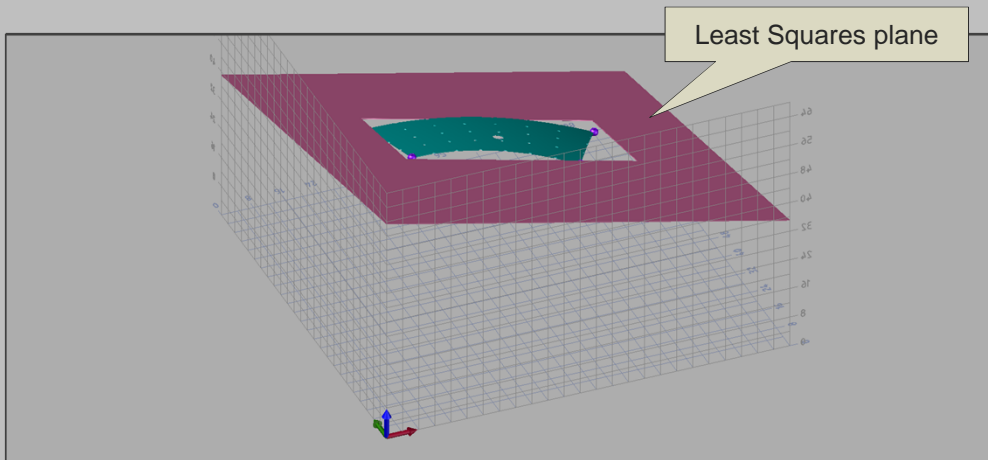

# Z-Coordinate of a plane

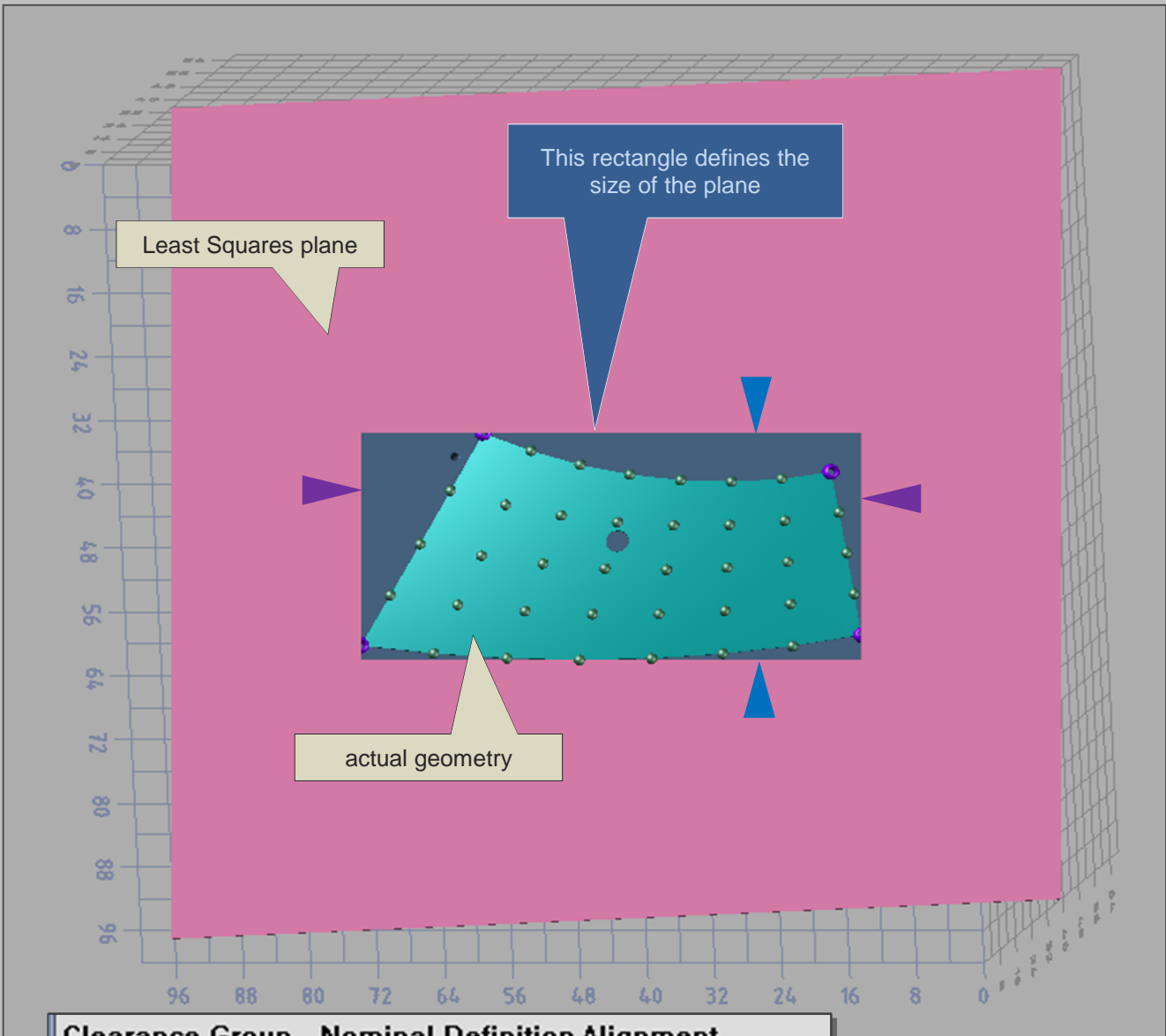

Clearance Group	Nominal Definition Alignment	
CP +Z	Recall Feature F	(Base Alignment)
<b>Tolerance For:</b>	<b>Nominal</b>	<b>Actual</b>
<input type="checkbox"/> X	22.4389	22.4389
<input type="checkbox"/> Y	42.8287	42.8287
<input type="checkbox"/> Z	45.1997	45.1997
<input type="checkbox"/> A1 X/Z	-11.5297	-11.5297
<input type="checkbox"/> A2 Y/Z	-13.6934	-13.6934
<b>Space Axis</b>	-Z	-Z
<b>Length 1</b>	27.8083	27.8083
<b>Length 2</b>	57.8585	57.8585
<b>Start Angle</b>	0.0000	0.0000

# Z-Coordinate of a plane

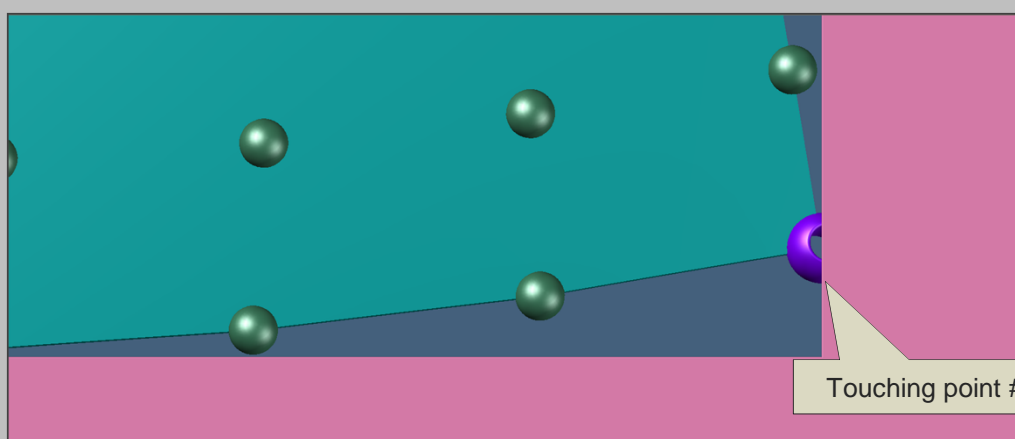
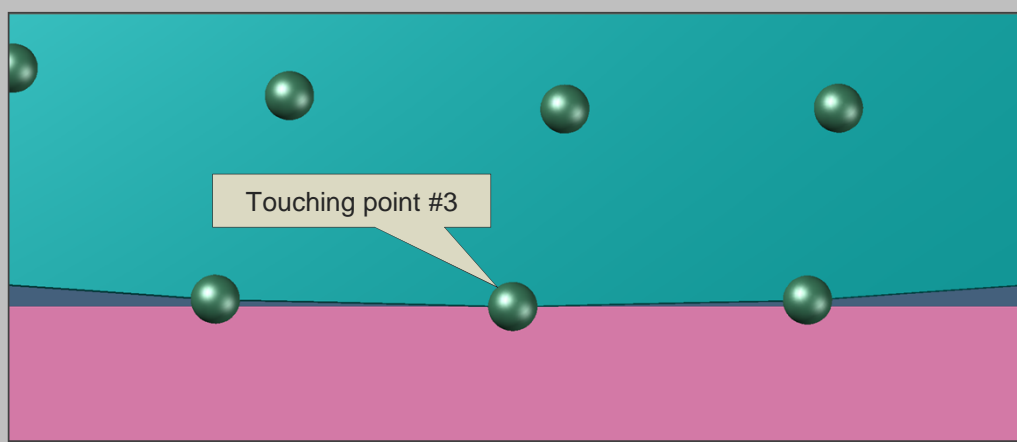
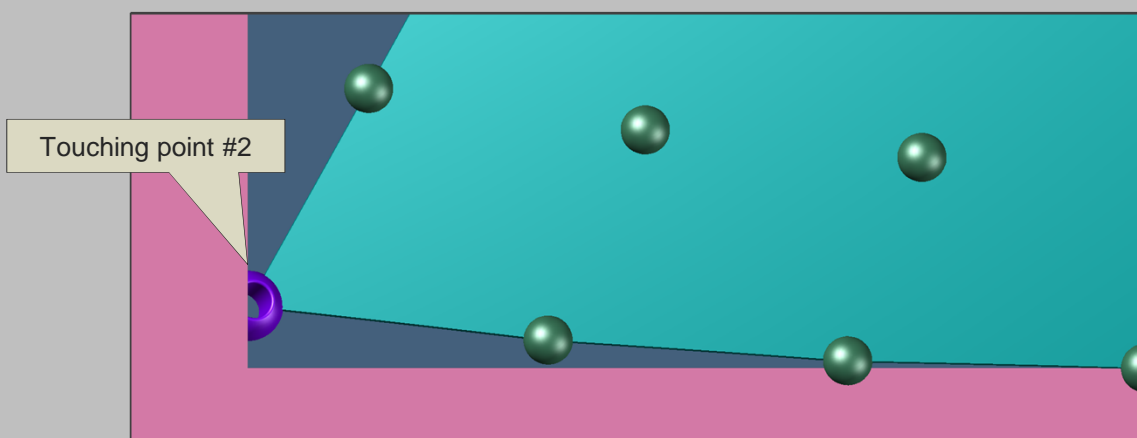
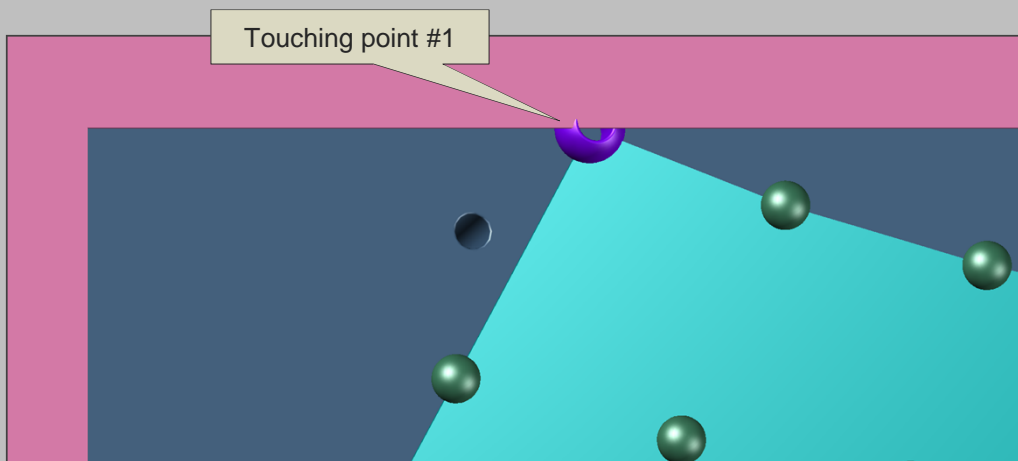

# Z-Coordinate of a plane

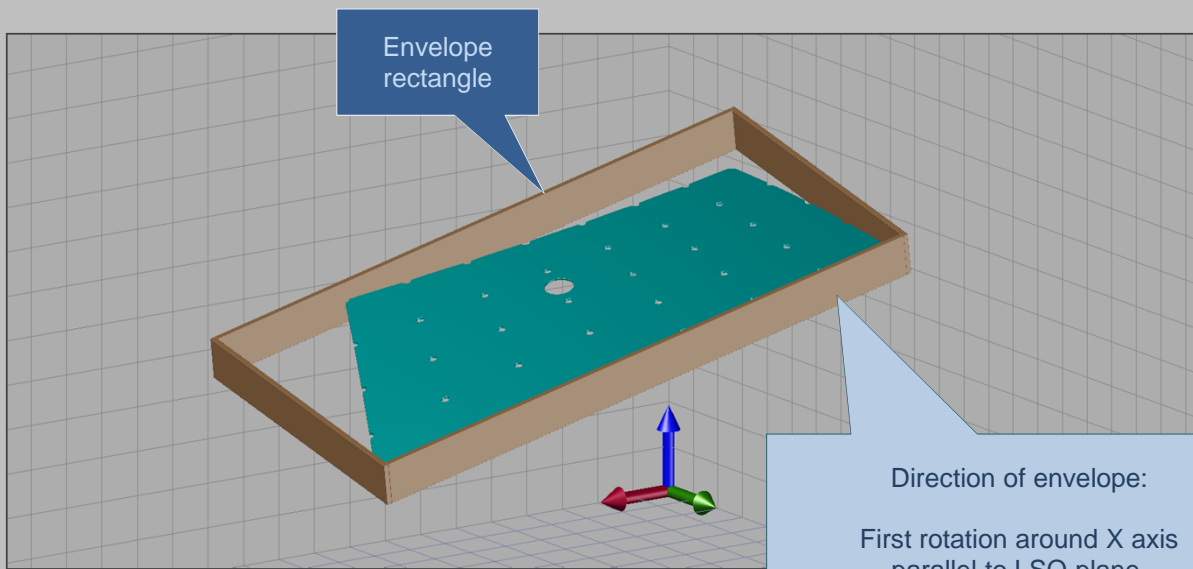
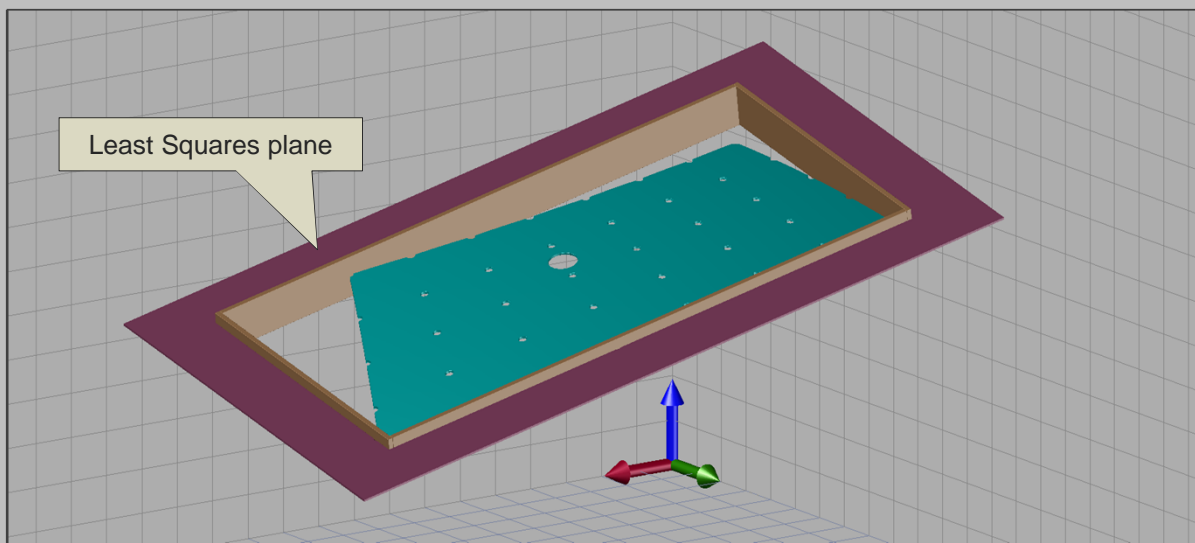

Direction of envelope:  
First rotation around X axis  
parallel to LSQ plane.  
Second rotation around rotated  
Y axis parallel to LSQ plane.

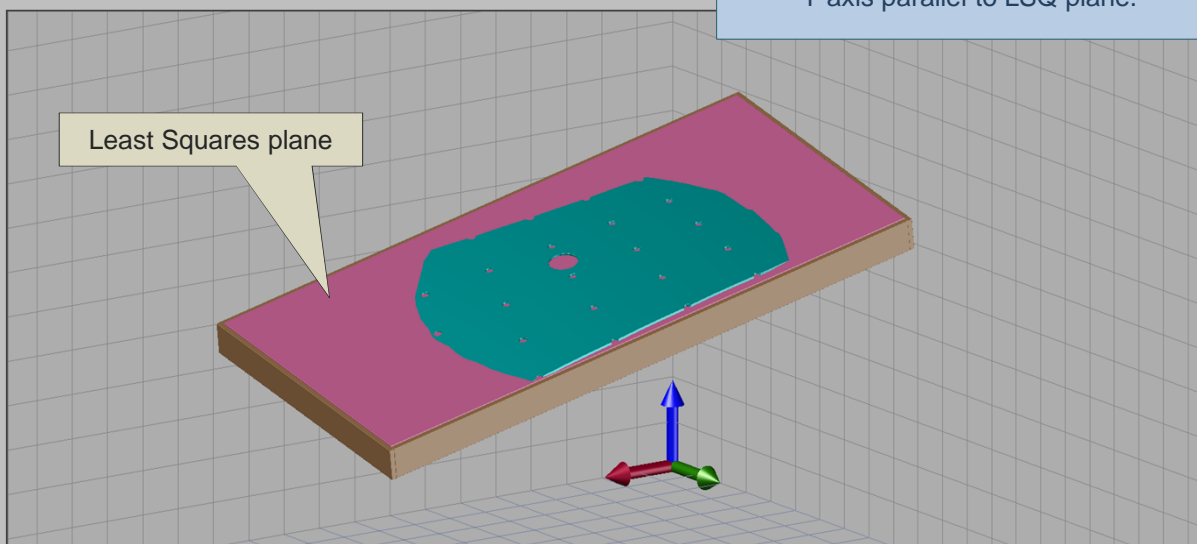

# Z-Coordinate of a plane

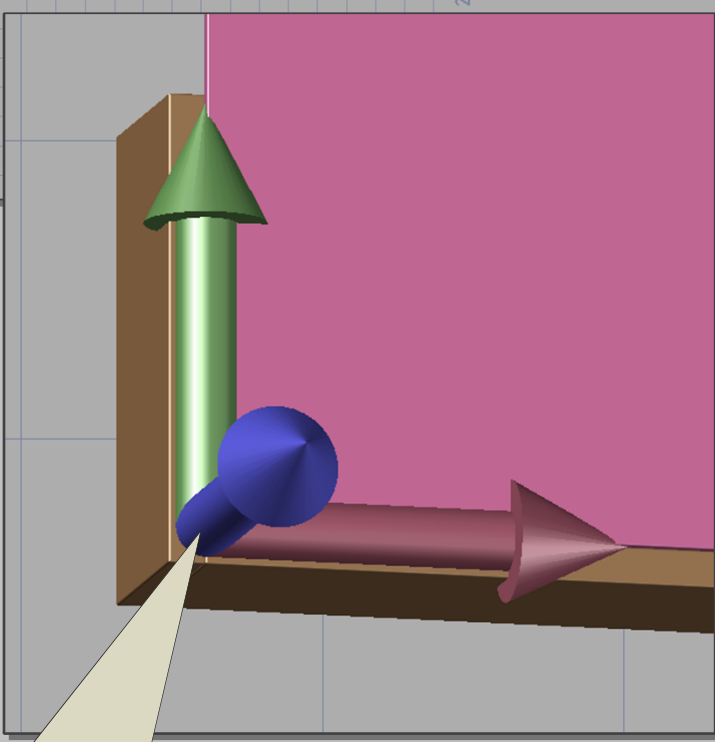
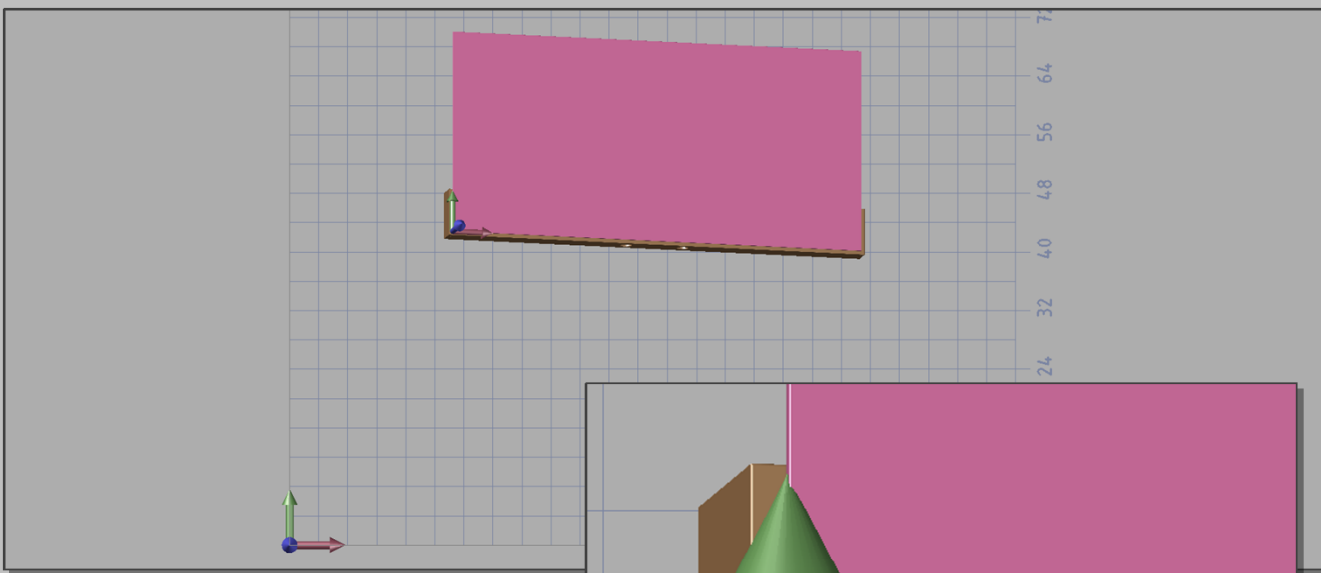
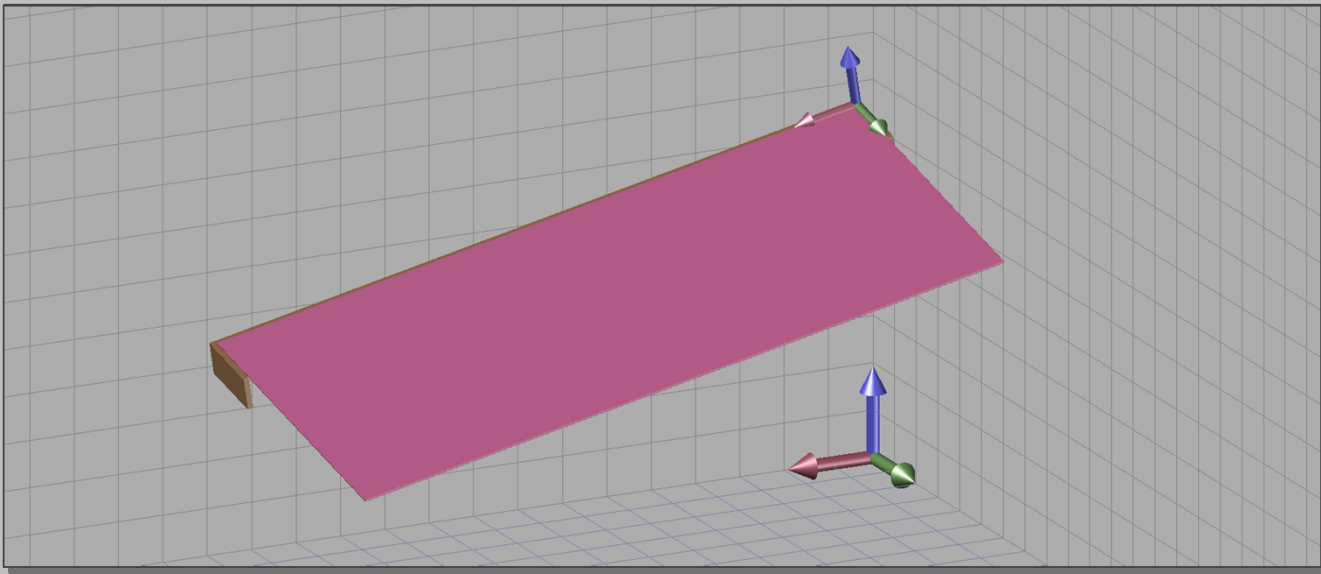

Local Element Coordinate System

# Z-Coordinate of a plane

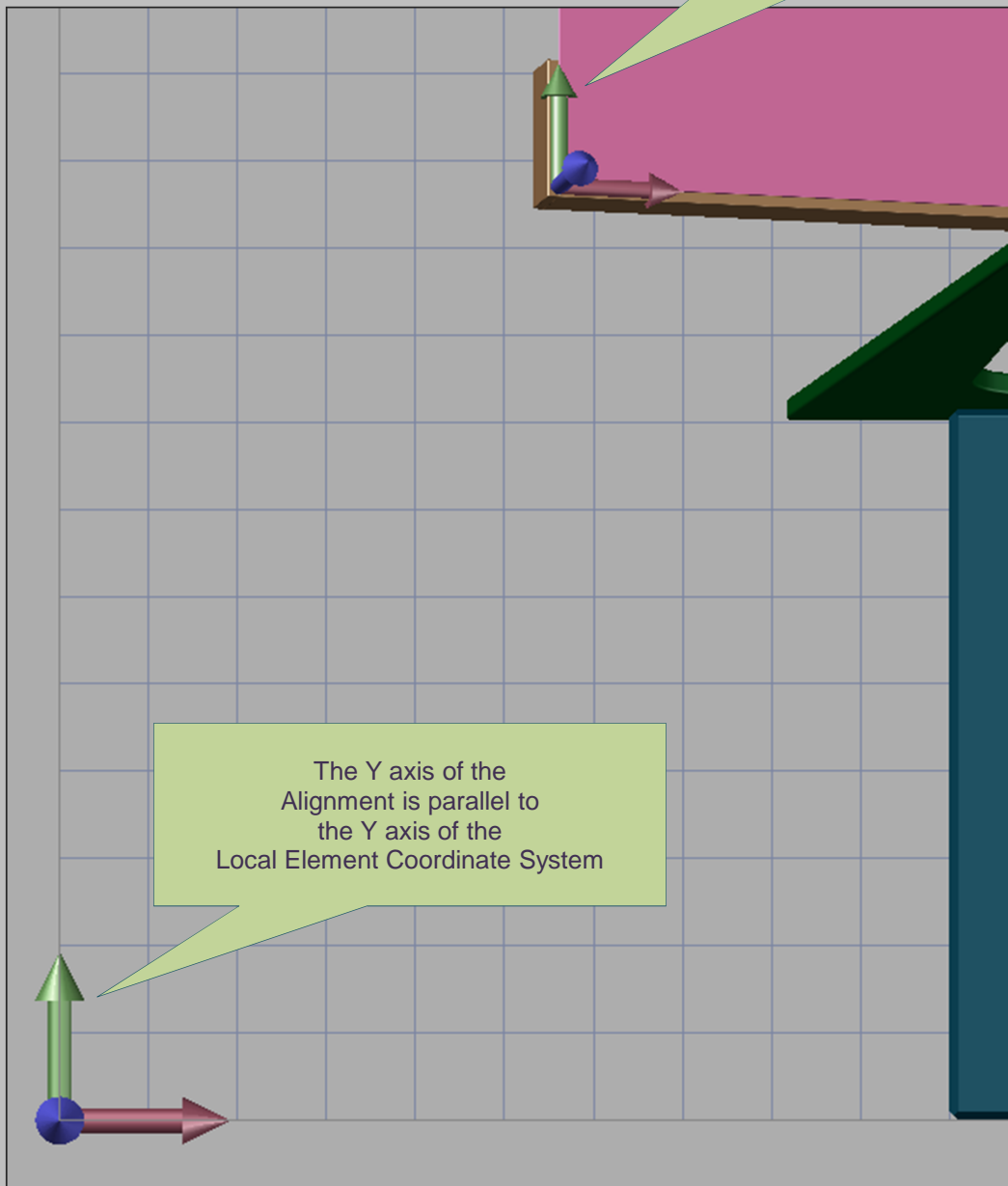
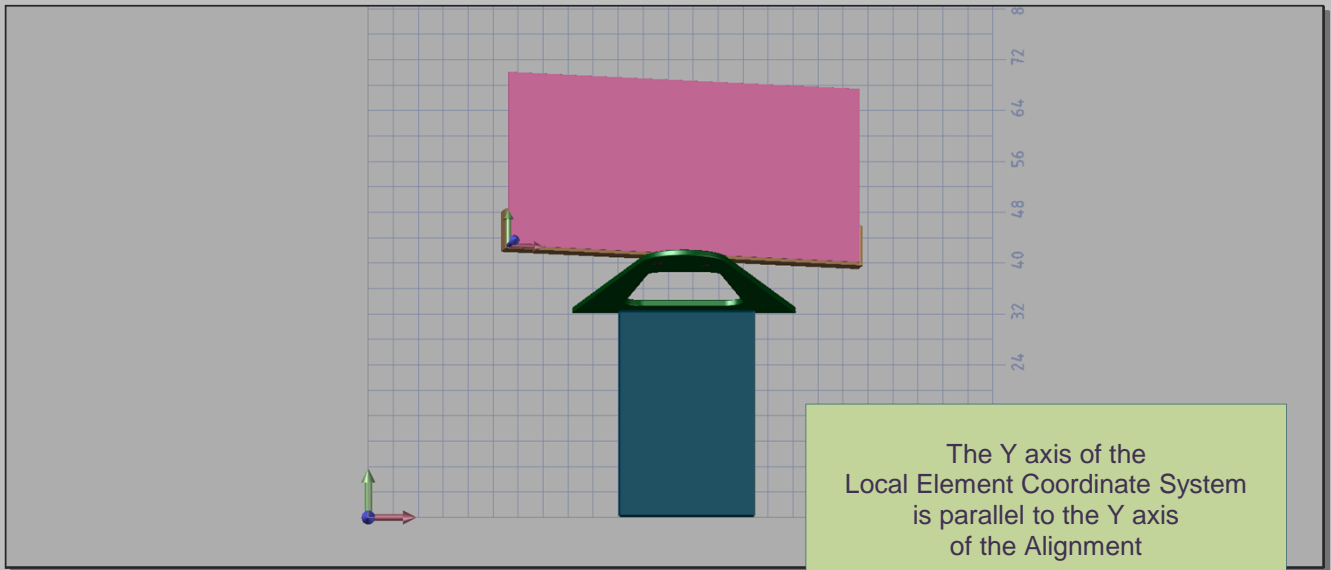



# Z-Coordinate of a plane

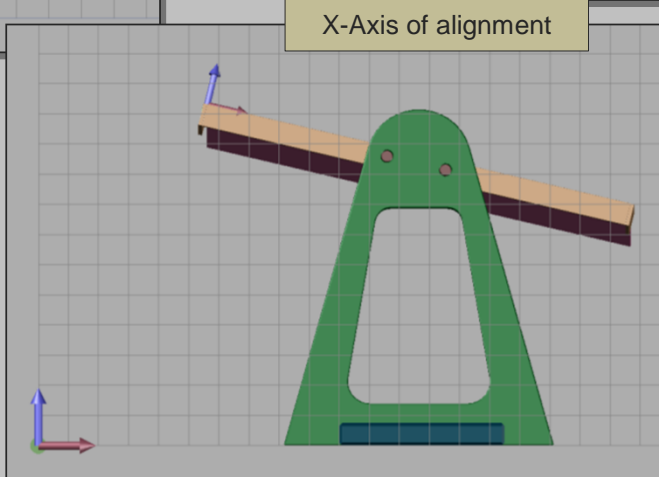
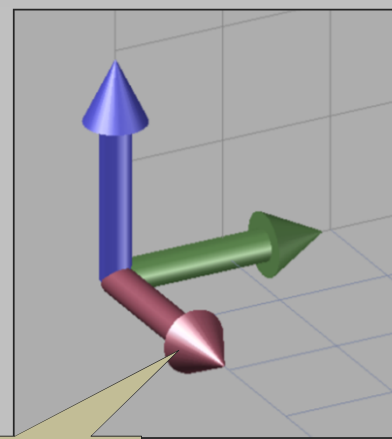
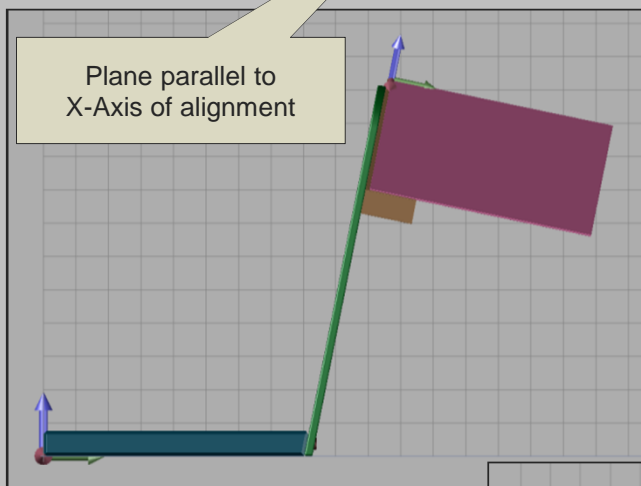
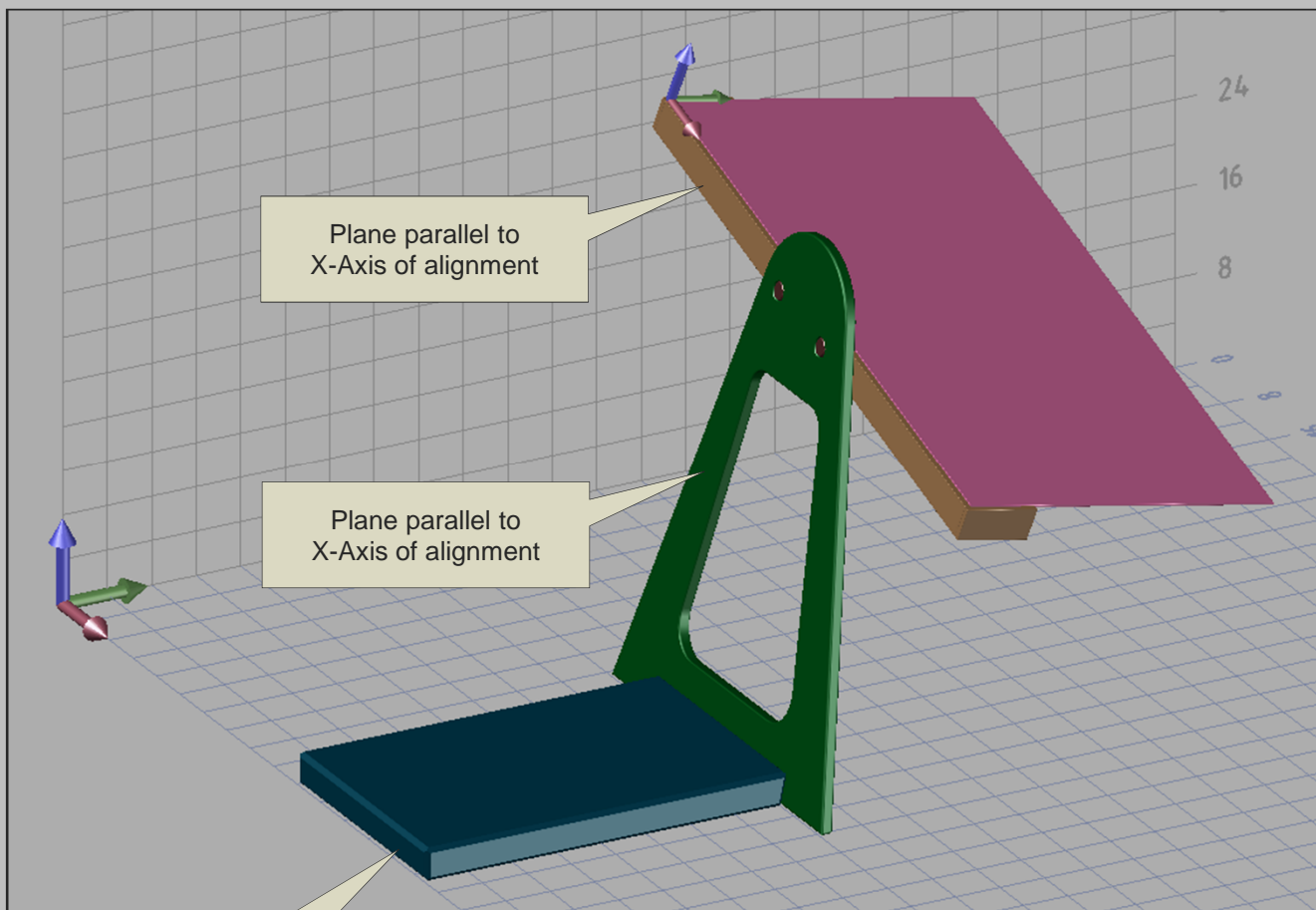

# Z-Coordinate of a plane

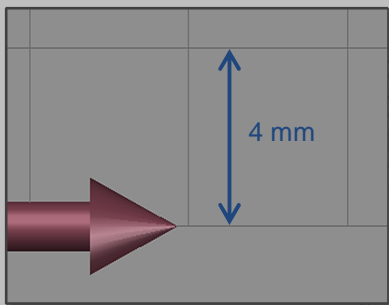
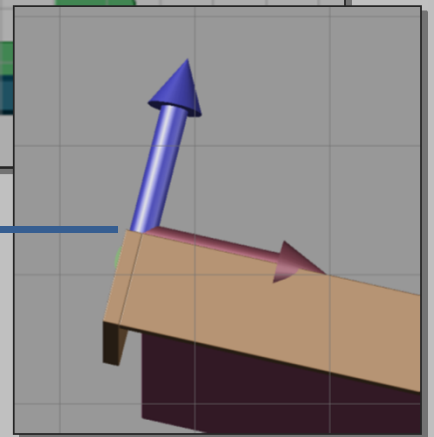
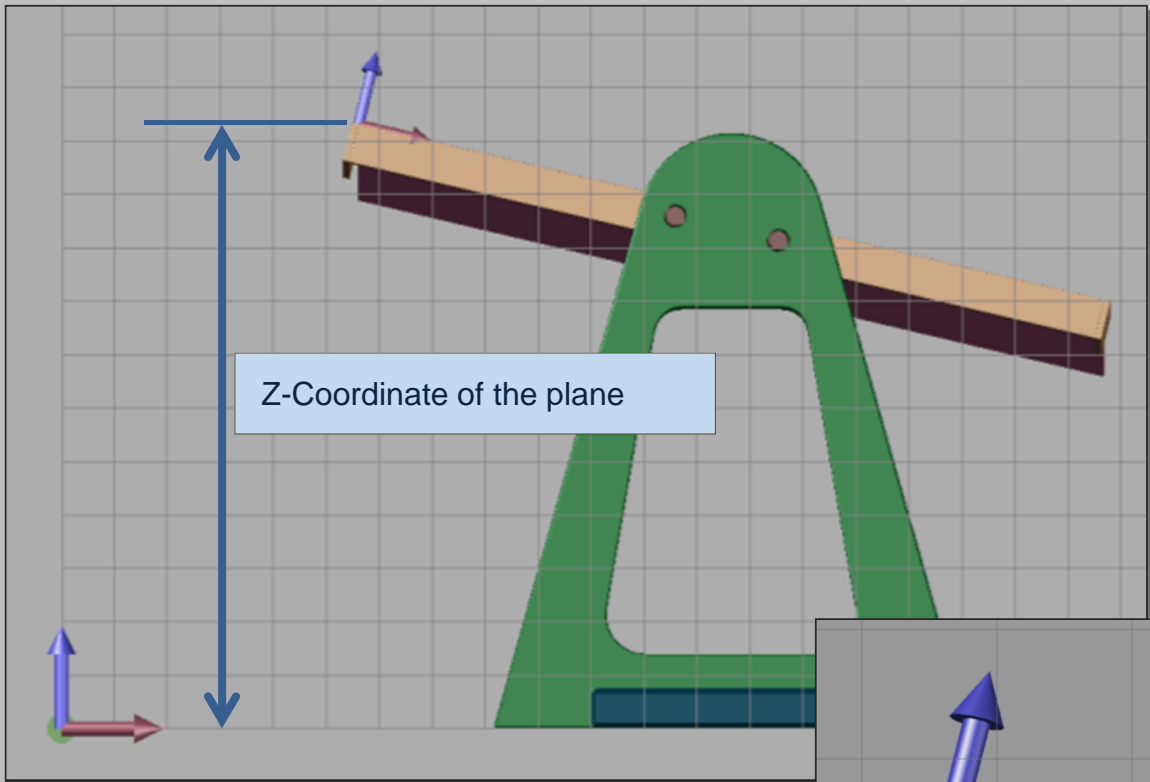

Clearance Group	Nominal Definition	Alignment
CP +Z	Recall Feature F	(Base Alignment)
<b>Tolerance For:</b>	<b>Nominal</b>	<b>Actual</b>
<input type="checkbox"/> X	22.4389	22.4389
<input type="checkbox"/> Y	42.8287	42.8287
<input type="checkbox"/> Z	45.1997	45.1997
<input type="checkbox"/> A1 X/Z	-11.5297	-11.5297
<input type="checkbox"/> A2 Y/Z	-13.6934	-13.6934
<b>Space Axis</b> ±	-Z	-Z
<b>Length 1</b>	27.8083	27.8083
<b>Length 2</b>	57.8585	57.8585
<b>Start Angle</b>	0.0000	0.0000

# Z-Coordinate of a plane

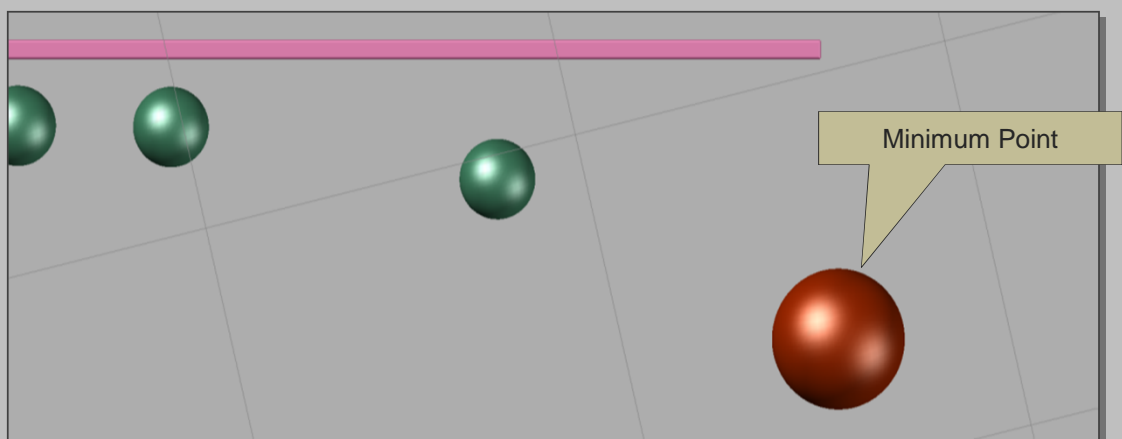
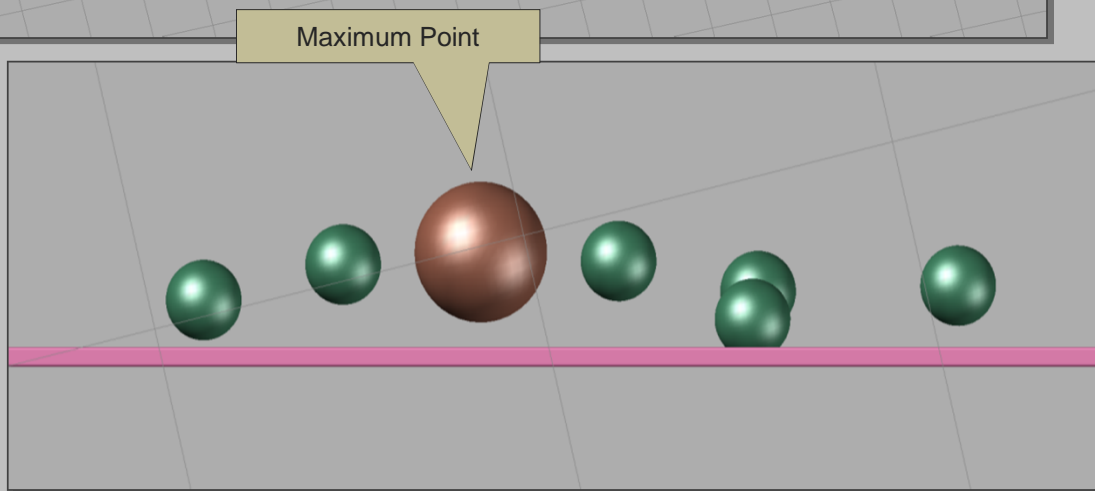
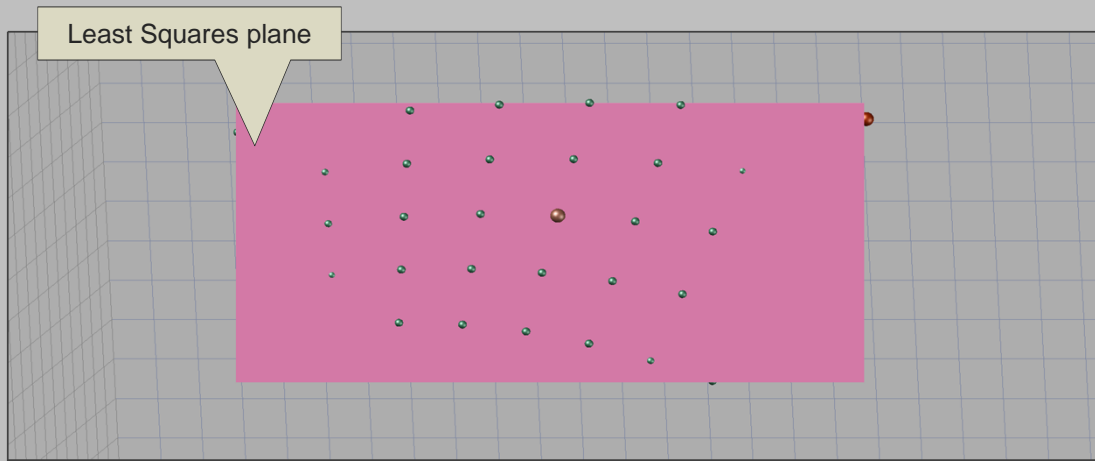

# Z-Coordinate of a plane

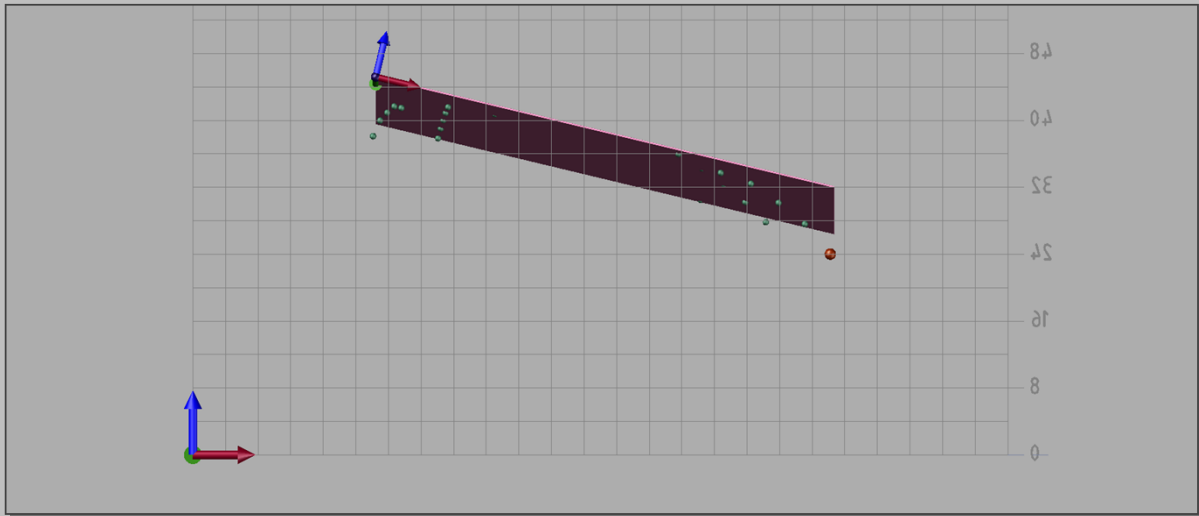

Maximum Point

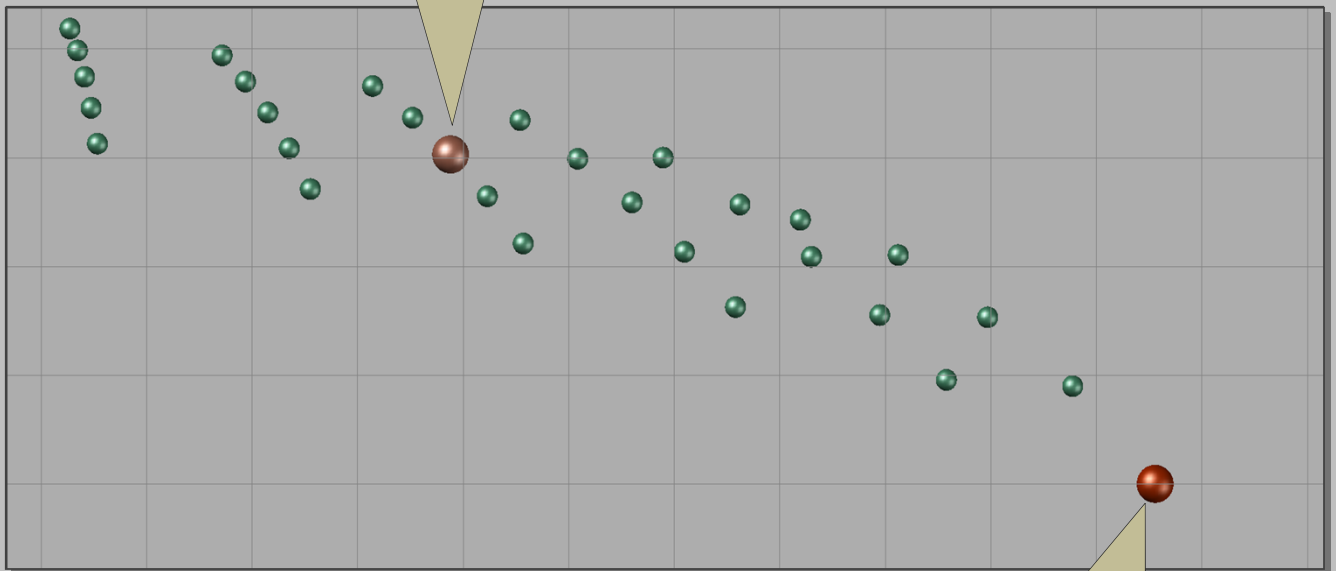

Minimum Point

LEC

