

A. Individual Measurement Plan

1. Open "Multiple Report"
2. Click the "New" drop down box under "Report Features" and select "Default Report"
3. Click the "TXT" icon to remove the "X" so you can output the report
4. Click the button with the 3 dots on it to open "Name definitions for output files for this Measurement Plan"

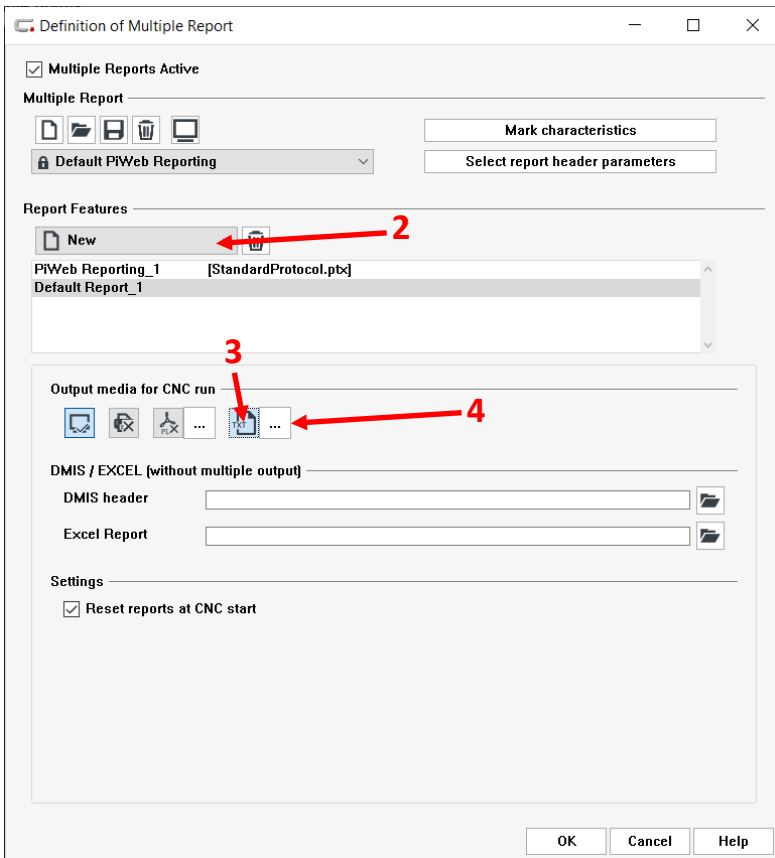

5. Select "Default Report"
6. Click "Name of output file variable"
7. Enter the path where you want to store the files

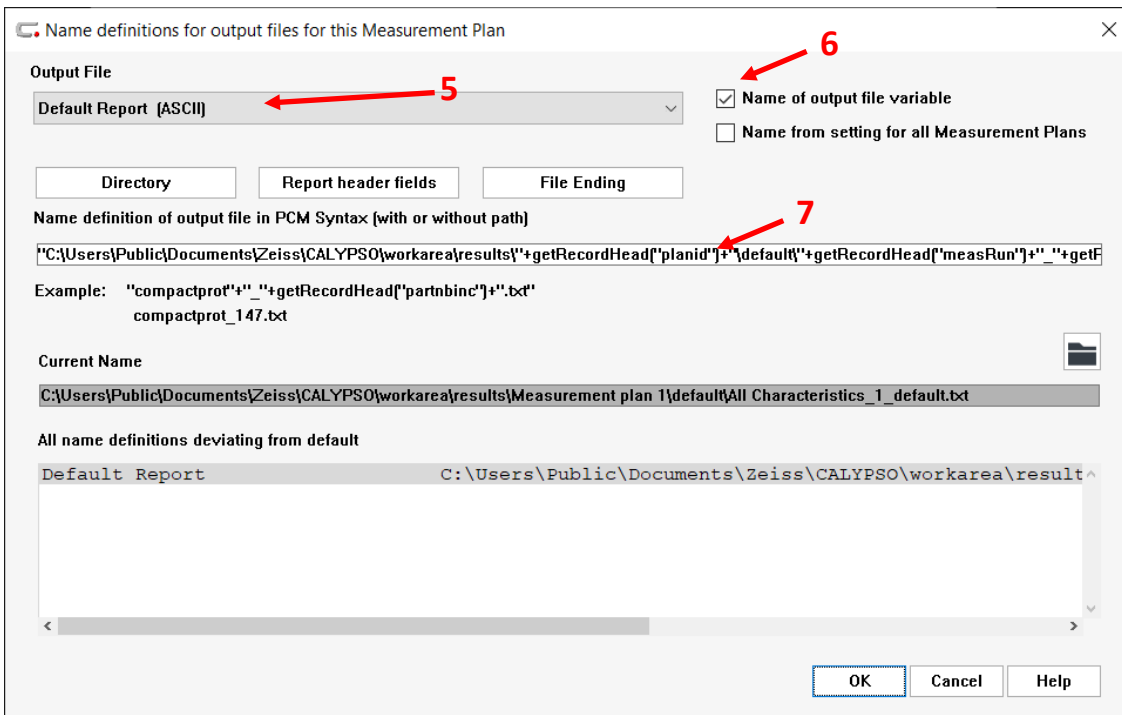

8. Click OK

B. All Measurement Plans

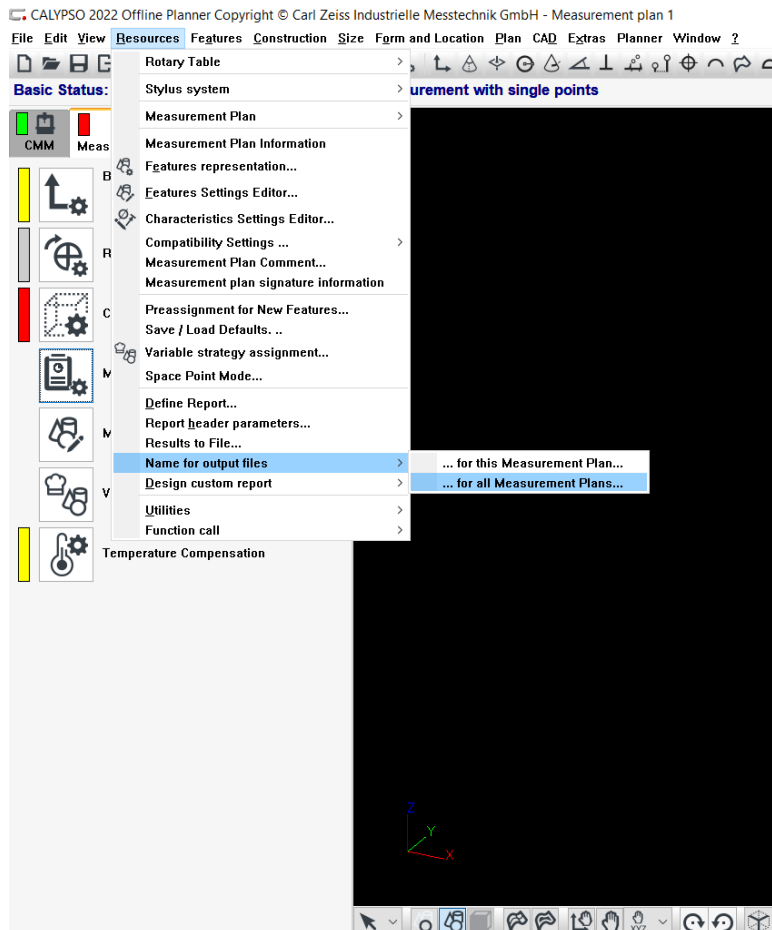

1. Select "Default Report"
2. Click "Name of output file variable"
3. Enter the path where you want to store the files

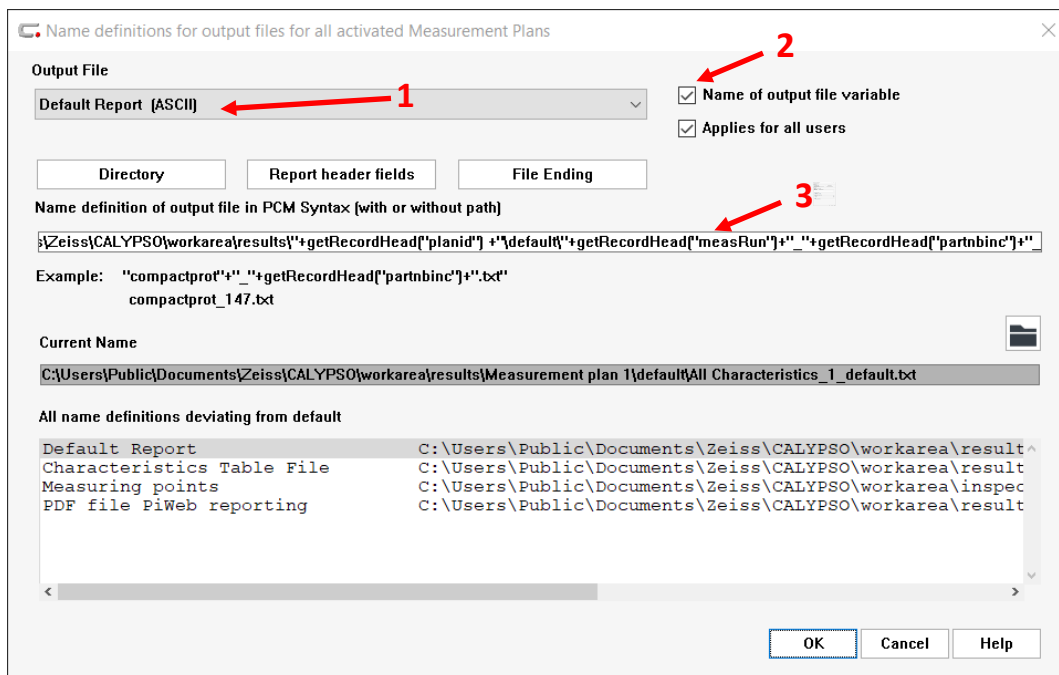

4. Click OK

5. Open "Multiple Report"
6. Click the "New" drop down box under "Report Features" and select "Default Report"
7. Click the "TXT" icon to remove the "X" so you can output the report
8. Click the button with the 3 dots on it to open "Name definitions for output files for this Measurement Plan"

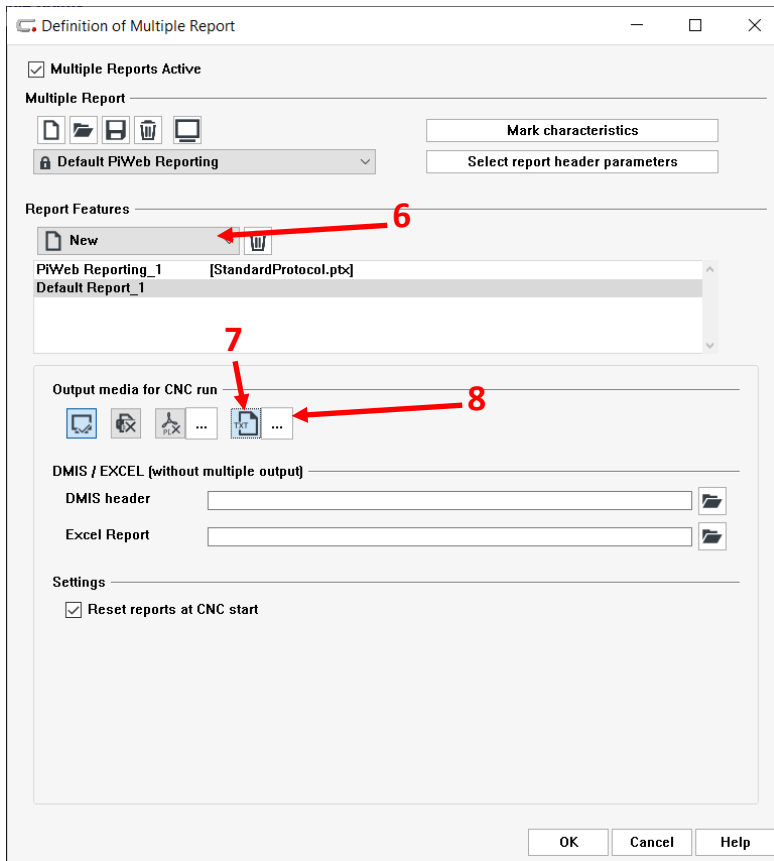

9. Select "Default Report"
10. Click "Name of output file variable"
11. Click "Name from setting for all Measurement Plans"

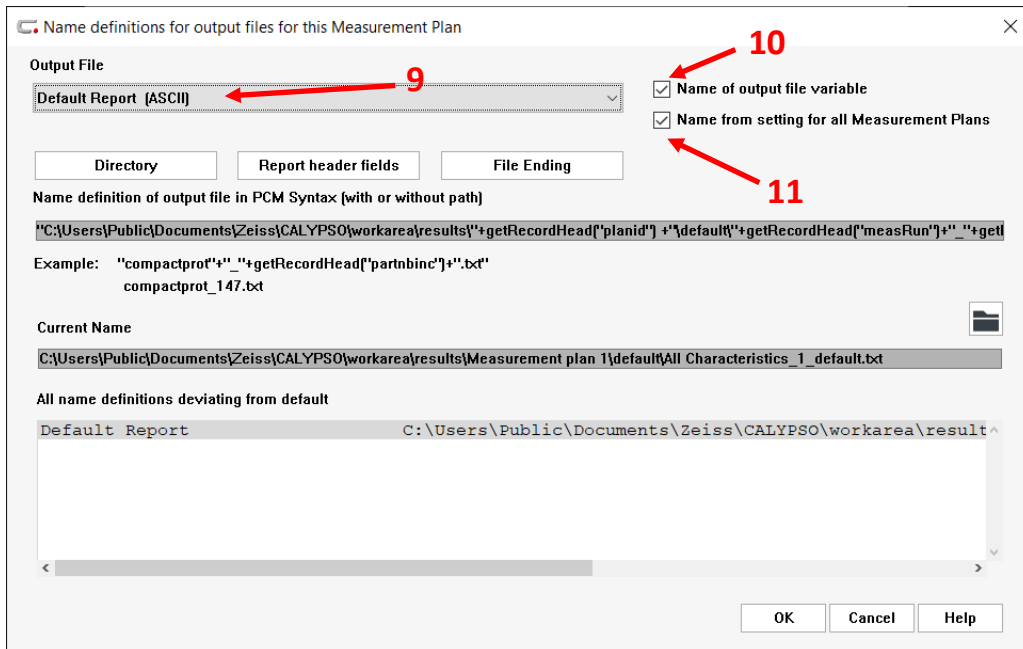

12. Click OK